

## APPLICATION / DESCRIPITON

Comprises a Fully Lugged Butterfly Valve fitted with gear operator with memory stop [DRV] and a stainless steel orifice plate.

The Butterfly Valve is fully lugged ductile iron, with bonded EPDM liner and stainless steel trim. Fitted with gear operator for infinitely variable settings and stainless steel memory stop to precisely set and retain the desired maximum opening position flow rate. Once set, the valve can be closed and re-opened accurately to the pre-set flowrate. The stainless steel orifice plate is to be close-coupled to measure and enable the flow rate to be set within an accuracy of  $\pm 5\%$ .

Commercially attractive option compared to a traditional Globe-style valve arrangement. Space saving and easier to support when weight is a concern. Available in large sizes up-to and including 600mm diameter.

## SPECIFICATION

### Butterfly Valve

Body:	Ductile Iron
Disc, Pin & Stem:	Stainless Steel
Seat:	Vulcanised EPDM
Operation:	Gearbox in Ductile Iron
Coating:	RAL 5015 (thickness 250 micron)
Standard:	BS EN 593
Dimensions:	Face-to-Face BS EN 558 (series 20)
Type:	<ul style="list-style-type: none"> <li>• Drilling: PN25</li> <li>• Shaft: SS AISI 431/630</li> <li>• Thread: Metric</li> </ul>
Tests:	Inspected acc. to BS EN 12266-1 & European PED #2014/68/EU, 15/05/2014, CE marked
Size:	Standard 65mm—600mm
Temperature Range:	-15 to 120 °C
Max. Working Pressure:	25 Bar

### Orifice Plate

Body and extension rod:	Stainless Steel
Test Points:	DZR Brass
Tests:	Inspected acc. to SEP & European PED #2014/68/EU, 15/05/2014, exempted from CE marking (Cf. Art. 4.3)
Temperature Range:	-20 to 120 °C BS EN 593
Max. Working Pressure:	25 Bar

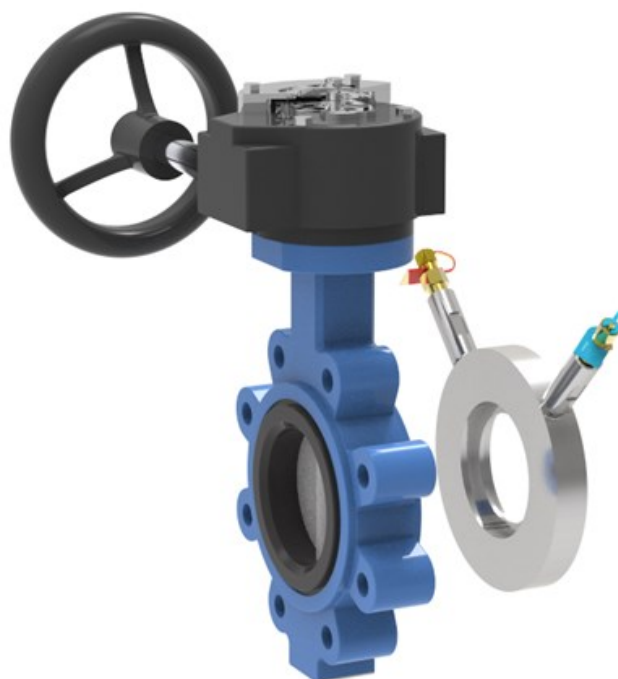

## FEATURES AND BENEFITS

- Robust ductile iron Butterfly Valve and Stainless Steel Orifice Plate for long service life
- Easy to install set and operate
- Positive position and reset memory stop feature
- Accurate flow measurement and precise setting
- Light weight and low cost
- Smaller [50mm] size available on request

## PRODUCT CODES VALVE ARRANGEMENT AND DIMENSIONS BUTTERFLY VALVES

Product Code	Size (DN)	H*	H1*	H3*	ØD2	N-M	C*	F*	ØV-V*	Kg	OTV (N.m)	BTV (N.m)	Gearbox		
													OT N-M	Ratio	N° of turns
LUGN50065MDVEPV2529COM	65	140	94	-	145	8-M16	65	154	135	11	26	86	200	24:1	6
LUGN50080MDVEPV2529COM	80	145	105	-	160	8-M16	65	154	135	11.6	35	86	200	24:1	6
LUGN50100MDVEPV2529COM	100	160	126	-	190	8-M20	65	154	135	15.3	60	169	200	24:1	6
LUGN50125MDVEPV2529COM	125	170	140	-	220	8-M24	65	154	135	19.8	93	291	200	24:1	6
LUGN50150MDVEPV2529COM	150	190	151	-	250	8-M24	65	154	135	20.5	153	291	200	24:1	6
LUGN50200MDVEPV2529COM	200	220	183	-	310	12-M24	77	225	285	33.1	288	992	500	32:1	8
LUGN50250MDVEPV2529COM	250	260	217	-	370	12-M27	77	225	285	56.5	485	1360	500	32:1	8
LUGN50300MDVEPV2529COM	300	290	252	-	430	16-M27	80	215	285	77.2	735	1563	1200	50:1	12.5
LUGN50350MDVEPV2529COM	350	320	285	-	490	16-M30	80	215	285	96.2	938	2356	1200	50:1	12.5
LUGN50400MDVEPV2530COM	400	356	325	271	550	16-M33	121	256	285	142.1	1269	3928	2.5x103	560:1	140
LUGN50450MDVEPV2530COM	450	387	384	271	600	20-M33	121	256	285	218.6	1697	5072	2.5x103	560:1	140
LUGN50500MDVEPV2530COM	500	424	392	271	600	20-M33	121	256	285	290.6	2147	6788	2.5x103	560:1	140
LUGN50600MDVEPV2530COM	600	524	455	330	770	20-M36	130	285	385	458.6	3452	10780	4x103	506:1	140

\*Dimensions are in mm. OTV: Operation Torque Value. BTV: Breaking Torque Value. Precise gear box measurements are available in the component data sheets.

### Butterfly Valve DN65 - 350

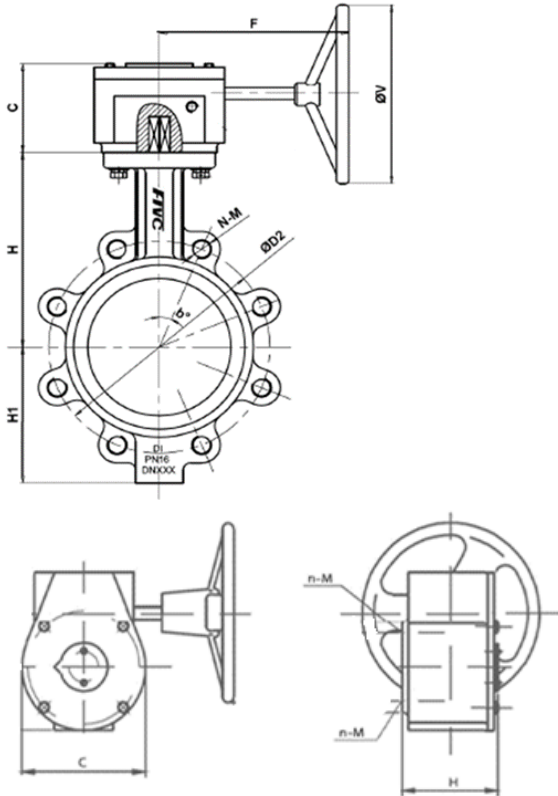

### Butterfly Valve DN400-600

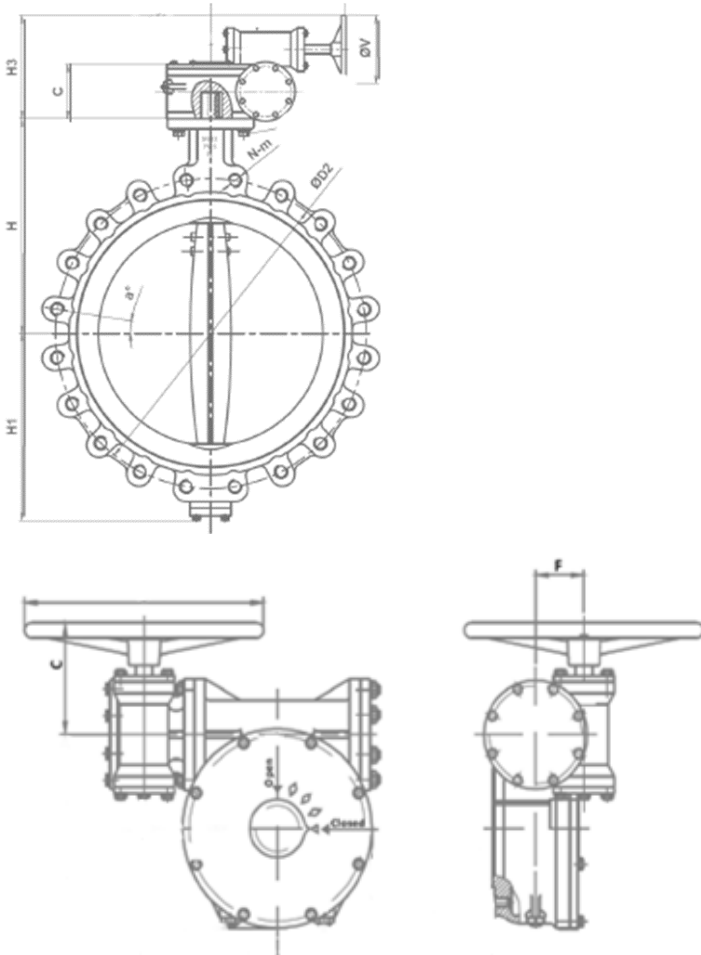

### DIMENSIONS ORIFICE PLATE

Size (DN)	L*	ØD*	ØD2*	T*	KV (m <sup>3</sup> /h)	Kg
65	145	127	54	20	88.6	1.3
80	152.5	142	65	20	150.6	2
100	165.5	168	84	20	281.1	2.5
125	178.5	194	103	20	328.8	3.3
150	193.5	224	125.2	20	477.5	3.8
200	223.5	284	164	20	826	5.8
250	251.5	340	202.5	20	1218	6.5
300	281.5	400	243.5	20	1794	12
350	310	457	270	20	2128.3	14.5
400	338.5	514	308	20	2765.8	18
450	363.5	564	342	30	3375.4	31.5
500	393.5	624	388	30	4407.1	33.5
600	446.5	730	478	30	6860.9	43.5

\*Dimensions are in millimeters

### Orifice Plate DN65 - 600

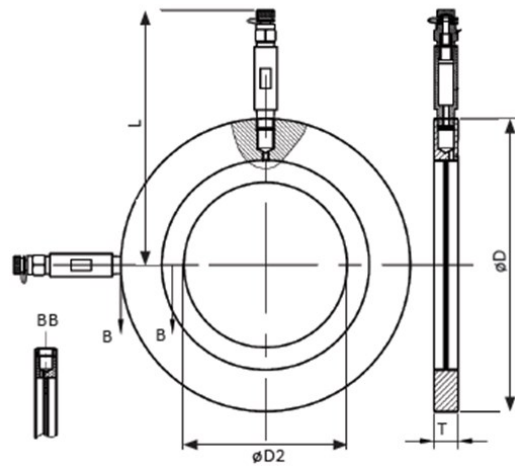

### INSTALLATION DIAGRAM

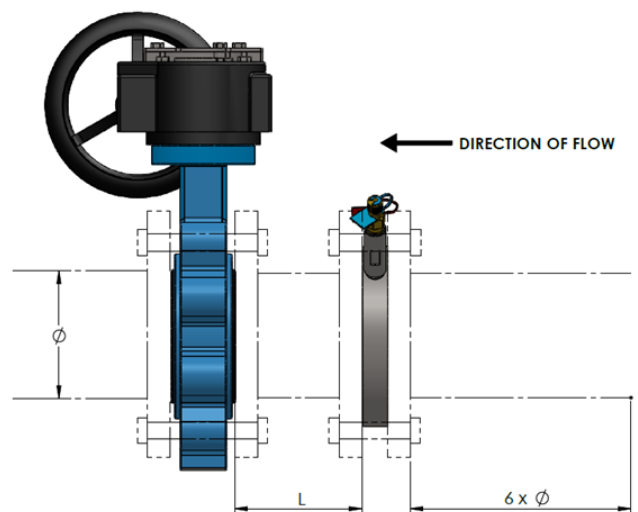

For all sizes: Spool piece length = line size diameter. The free length upstream = 6 x line size Ø.

Note: The spool piece in the drawing is supplied by the contractor.

SELECTIONS

65mm Butterfly Valve/Orifice Plate Commissioning Set  
 Flow range: 2.70 – 6.60 l/s

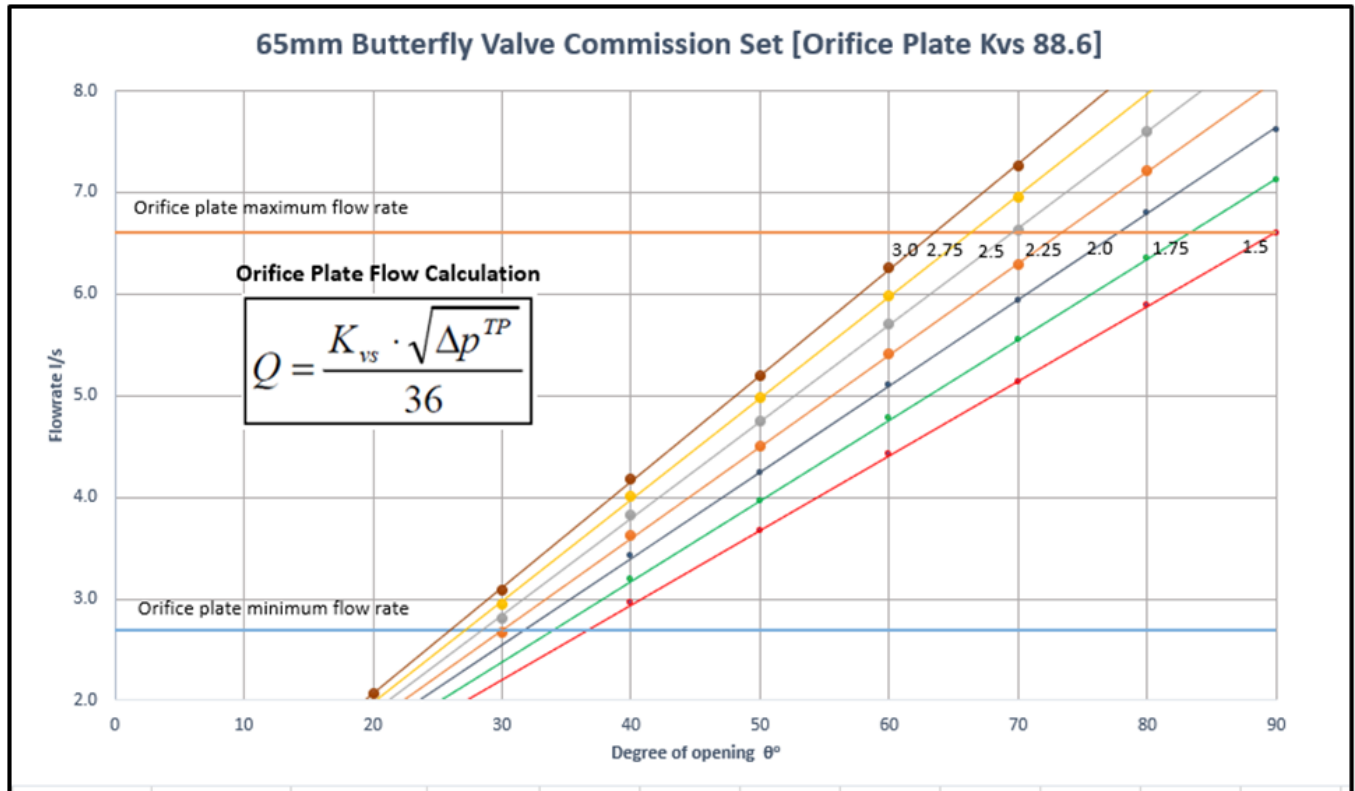

80mm Butterfly Valve/Orifice Plate Commissioning Set  
 Flow range: 3.80 – 11.5 l/s

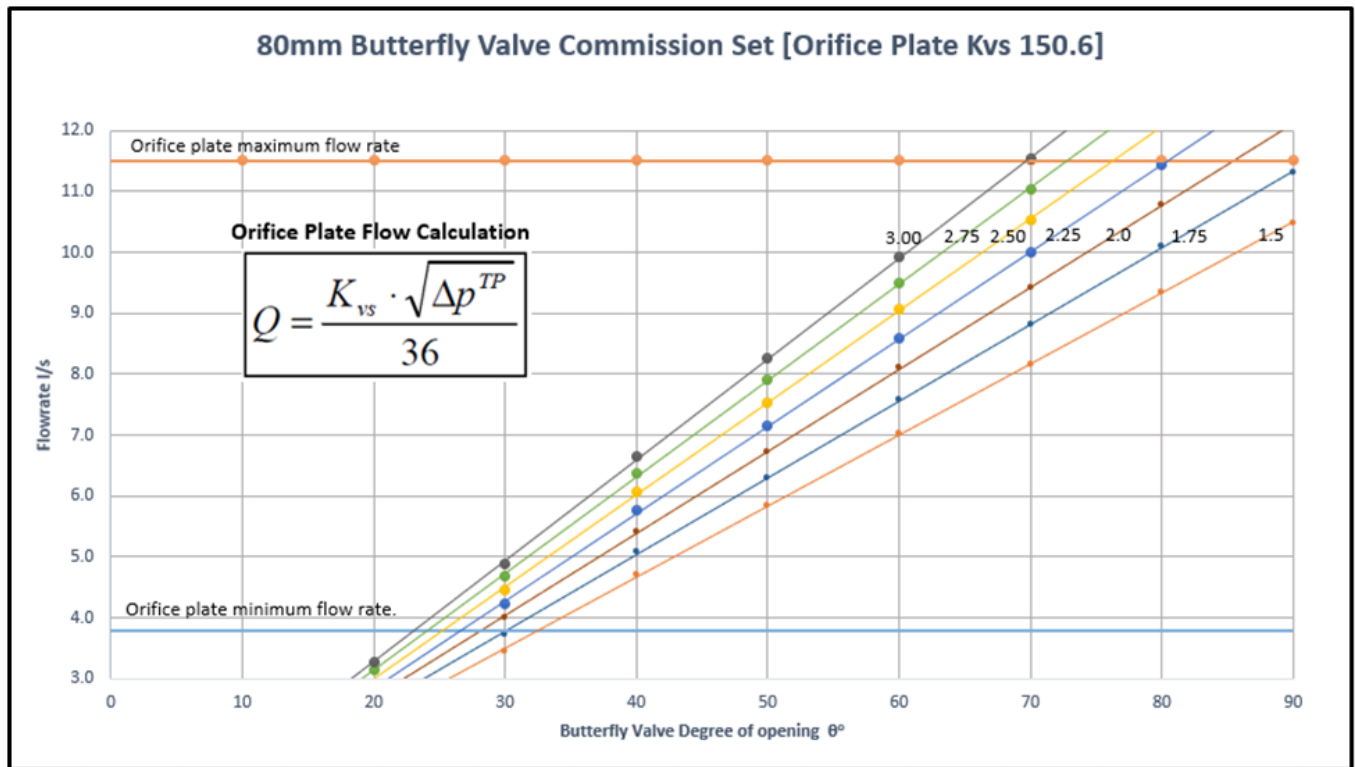

SELECTIONS

100mm Butterfly Valve/Orifice Plate Commissioning Set  
 Flow range: 8.00 – 21.00 l/s

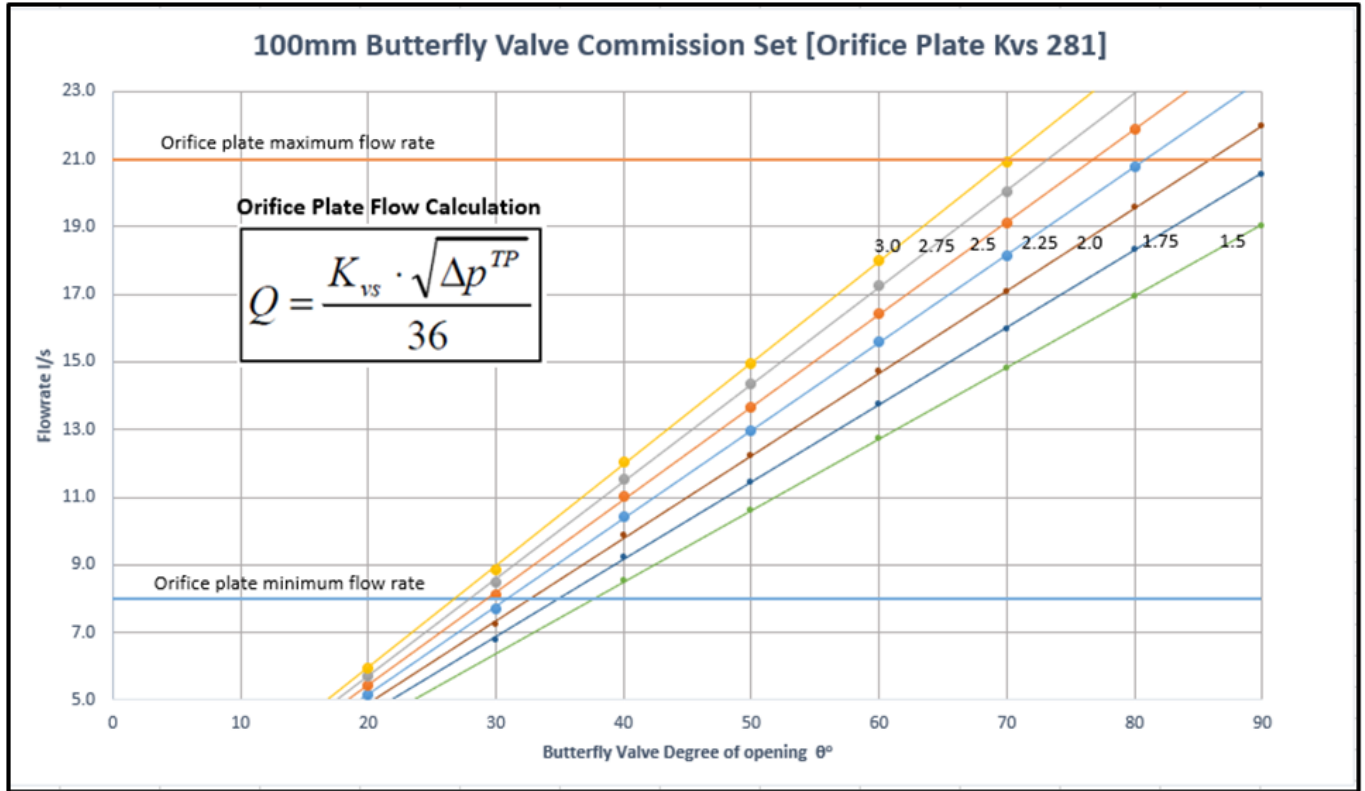

125mm Butterfly Valve/Orifice Plate Commissioning Set  
 Flow range: 9.4 – 33.0 l/s

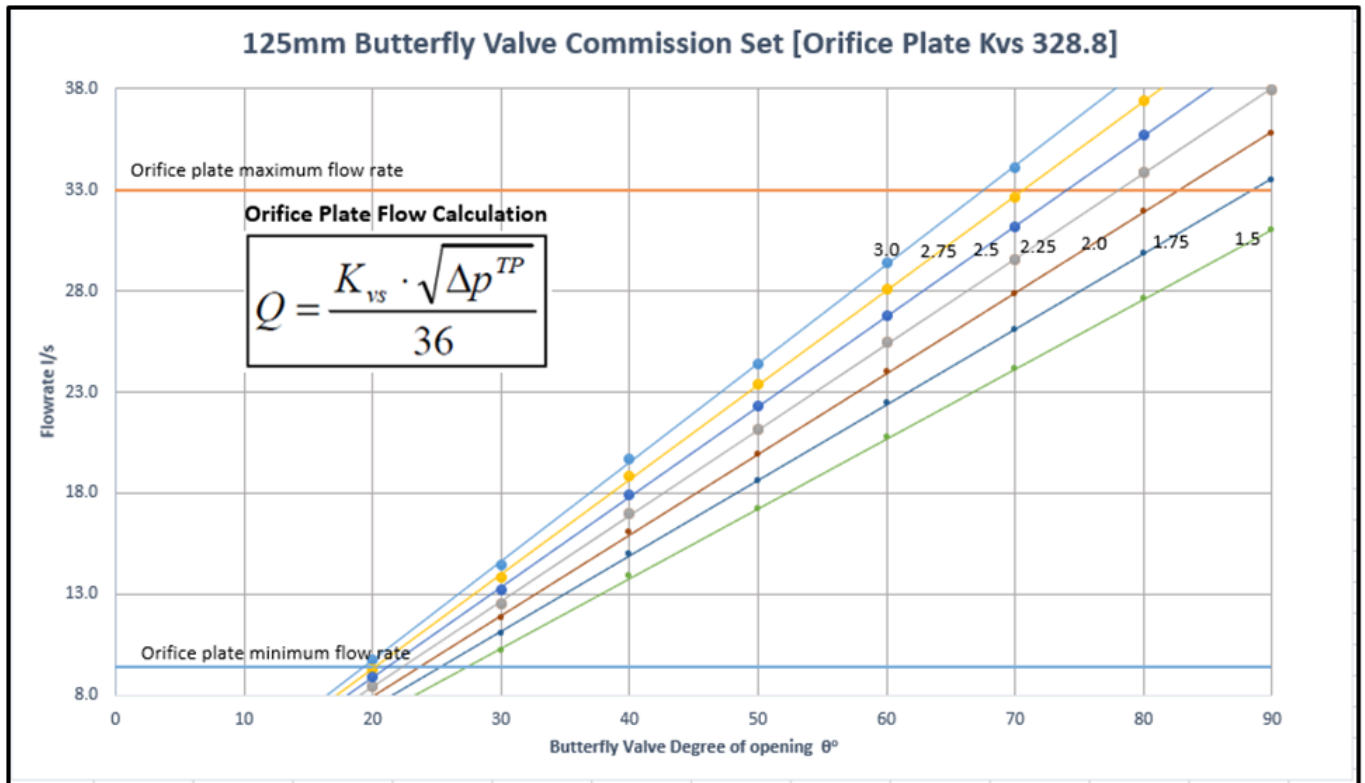

SELECTIONS

150mm Butterfly Valve/Orifice Plate Commissioning Set

Flow range: 12.74 – 47.00 l/s

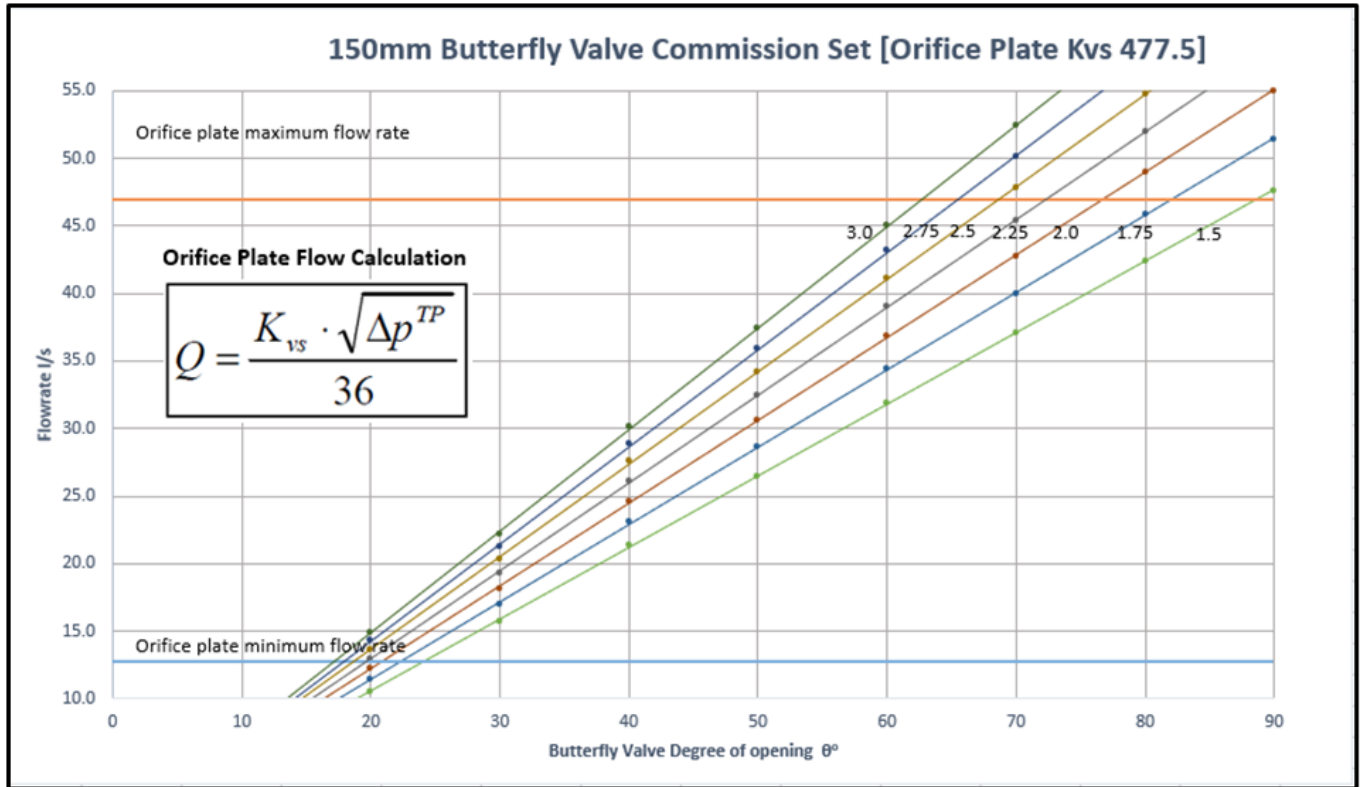

200mm Butterfly Valve/Orifice Plate Commissioning Set

Flow range: 23.8 – 95.00 l/s

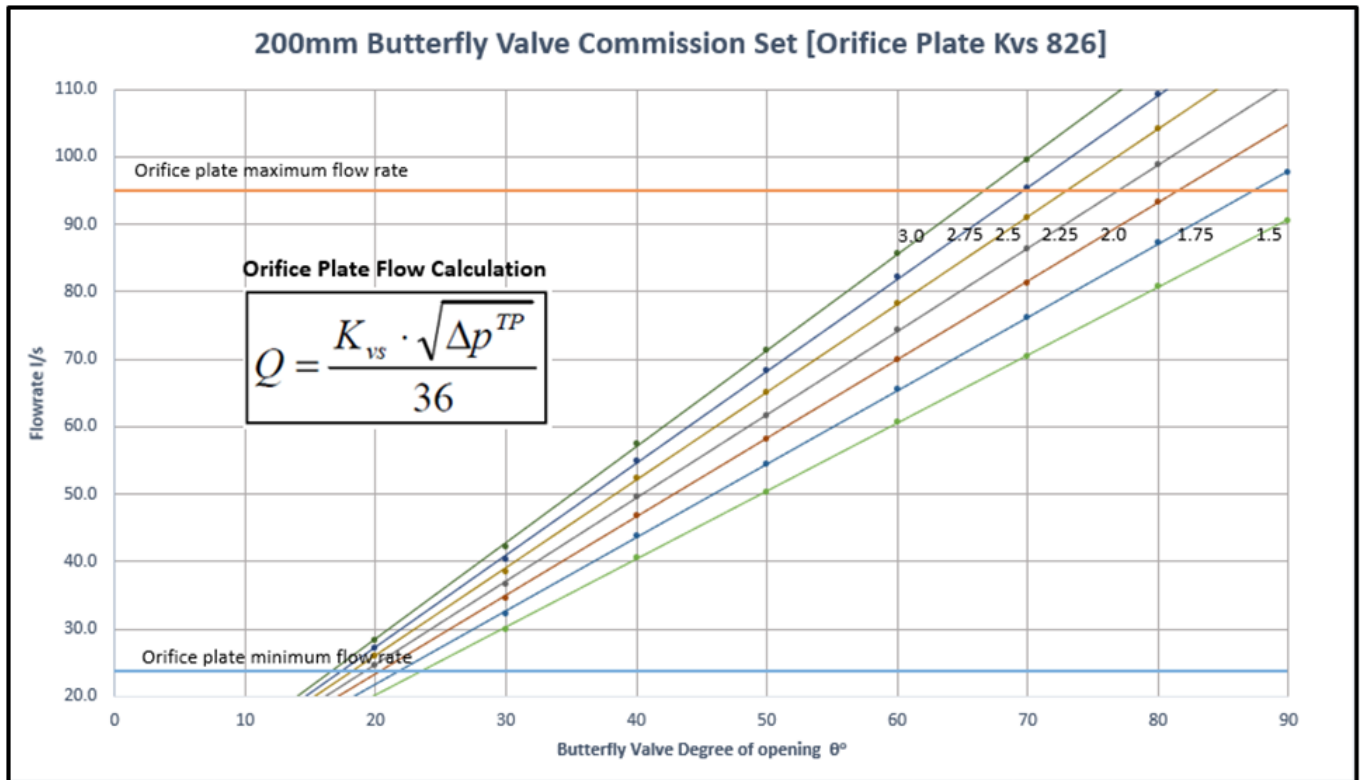

SELECTIONS

250mm Butterfly Valve/Orifice Plate Commissioning Set  
 Flow range: 34.3 – 145.00 l/s

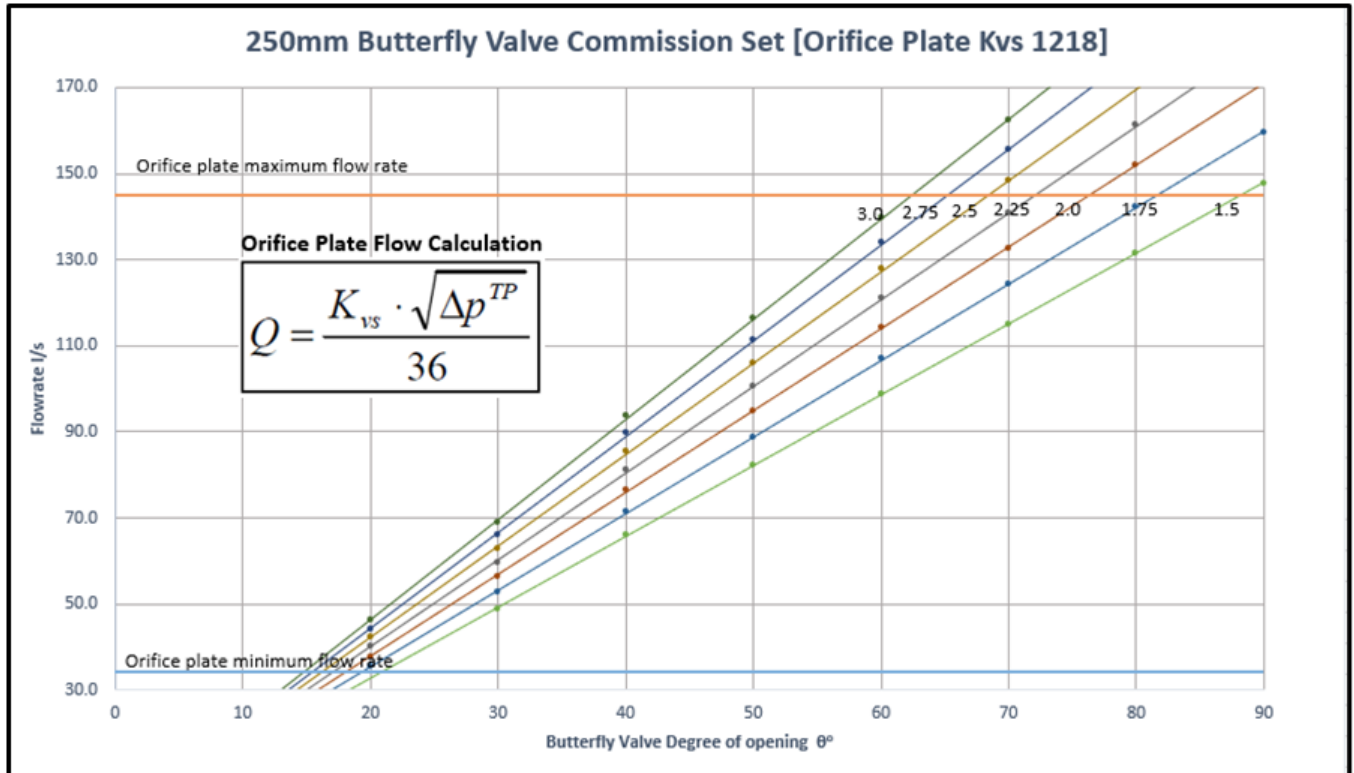

300mm Butterfly Valve/Orifice Plate Commissioning Set  
 Flow range: 49.0 – 222.00 l/s

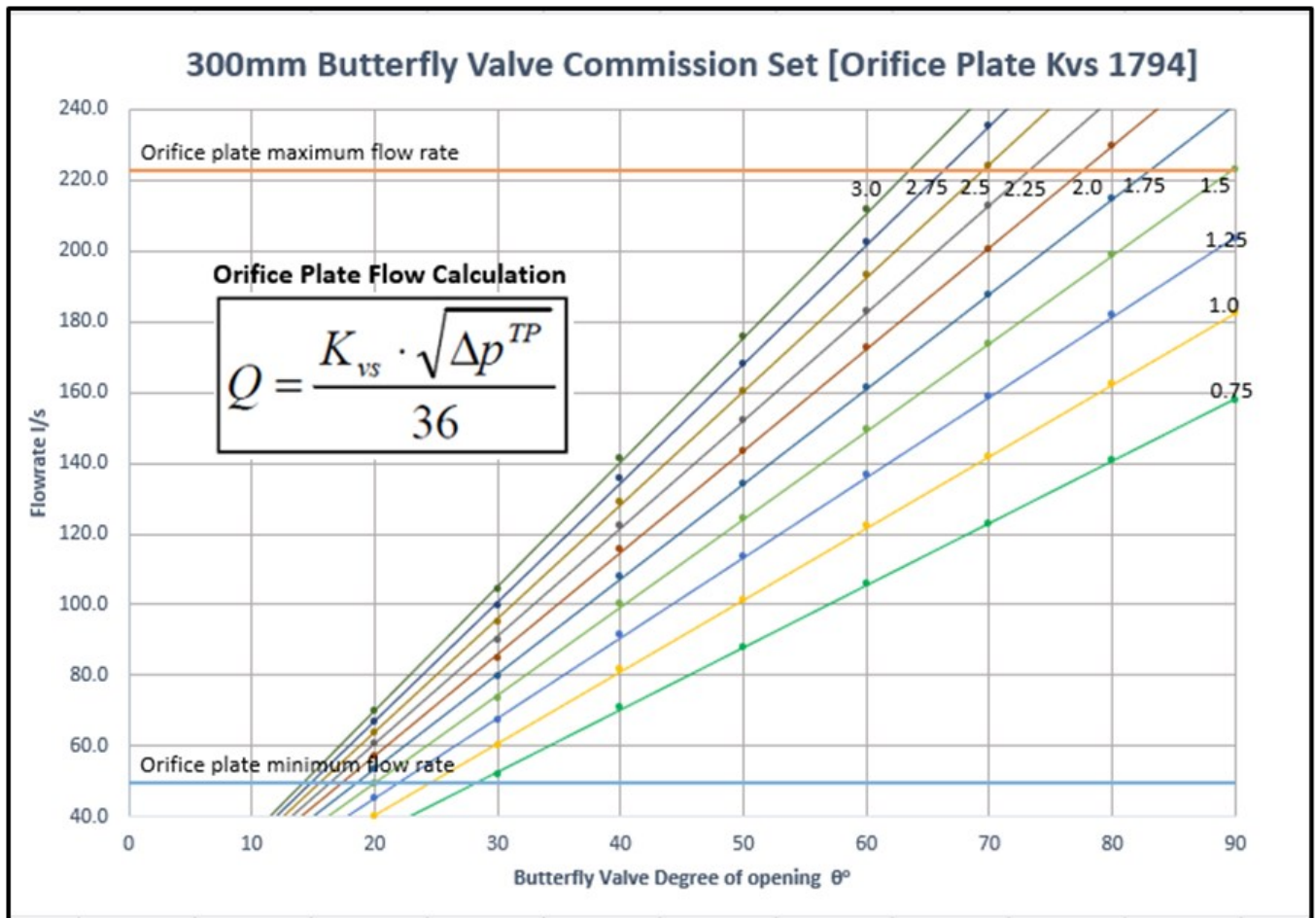

### SELECTIONS

350mm Butterfly Valve/Orifice Plate Commissioning Set

Flow range: 62 – 260.00 l/s

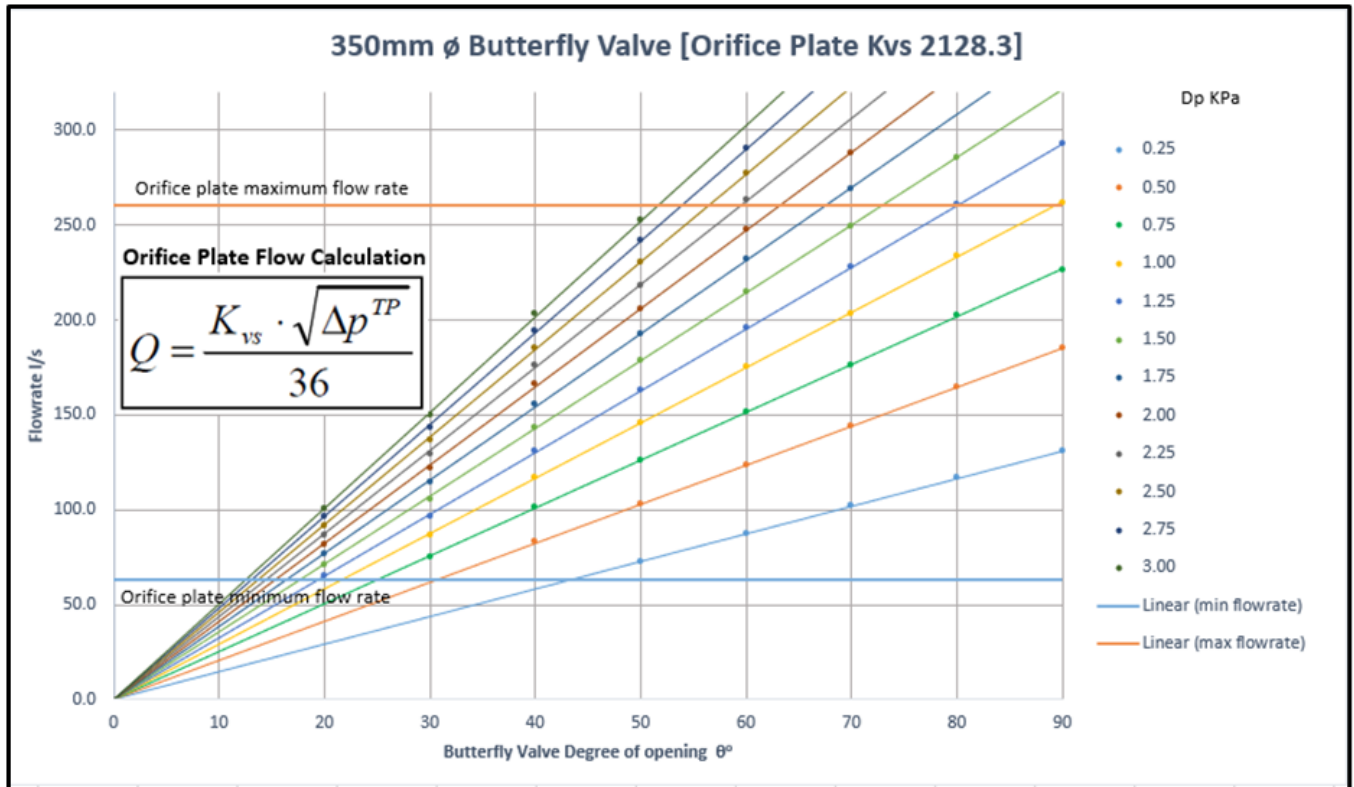

400mm Butterfly Valve/Orifice Plate Commissioning Set

Flow range: 82 – 360.00 l/s

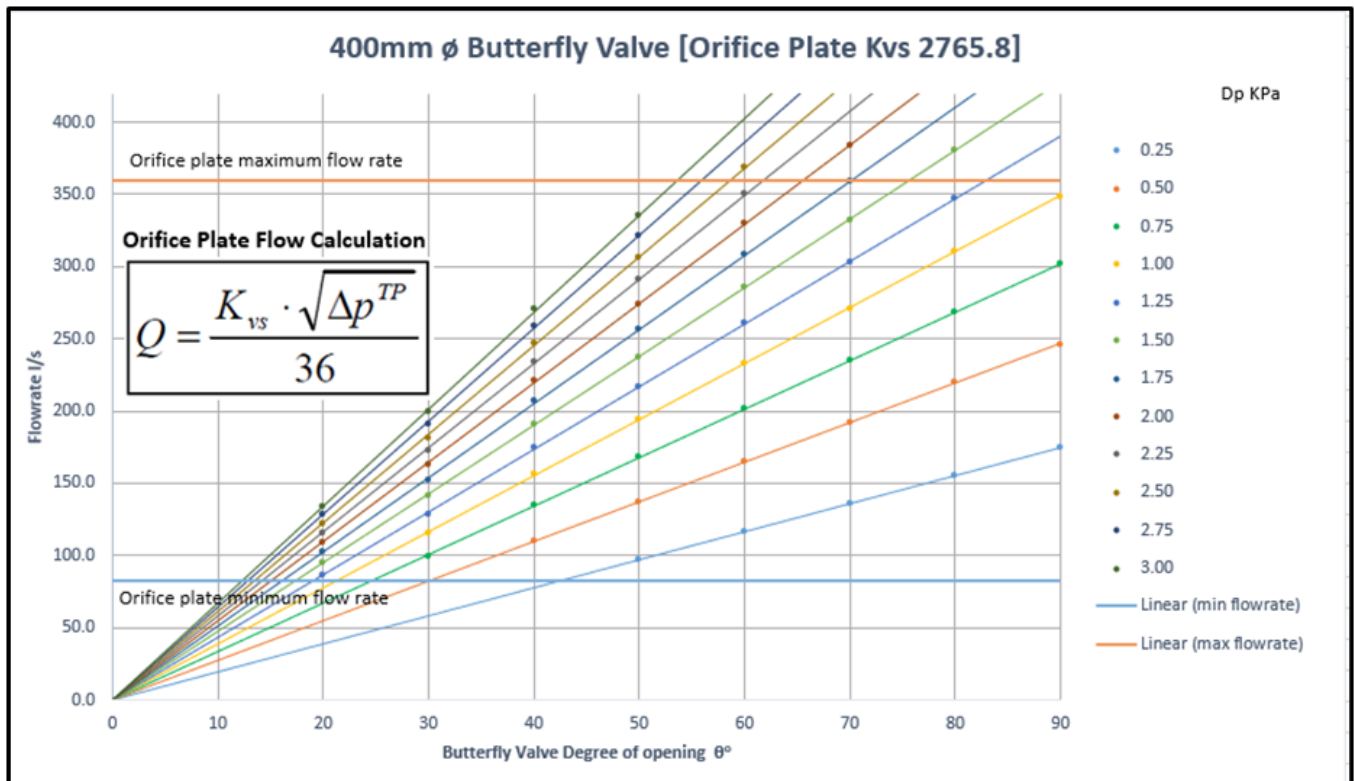

### SELECTIONS

450mm Butterfly Valve/Orifice Plate Commissioning Set

Flow range: 103 – 460.00 l/s

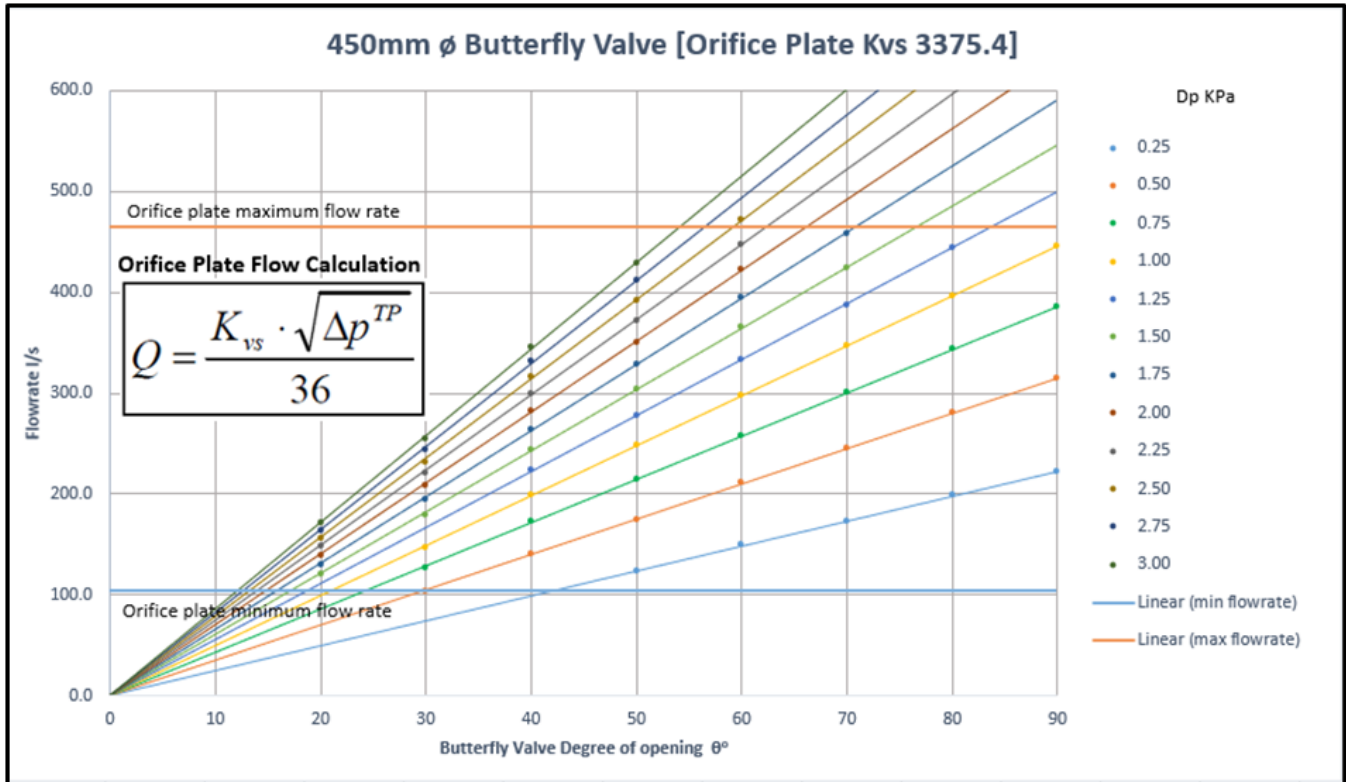

500mm Butterfly Valve/Orifice Plate Commissioning Set

Flow range: 133 – 590.00 l/s

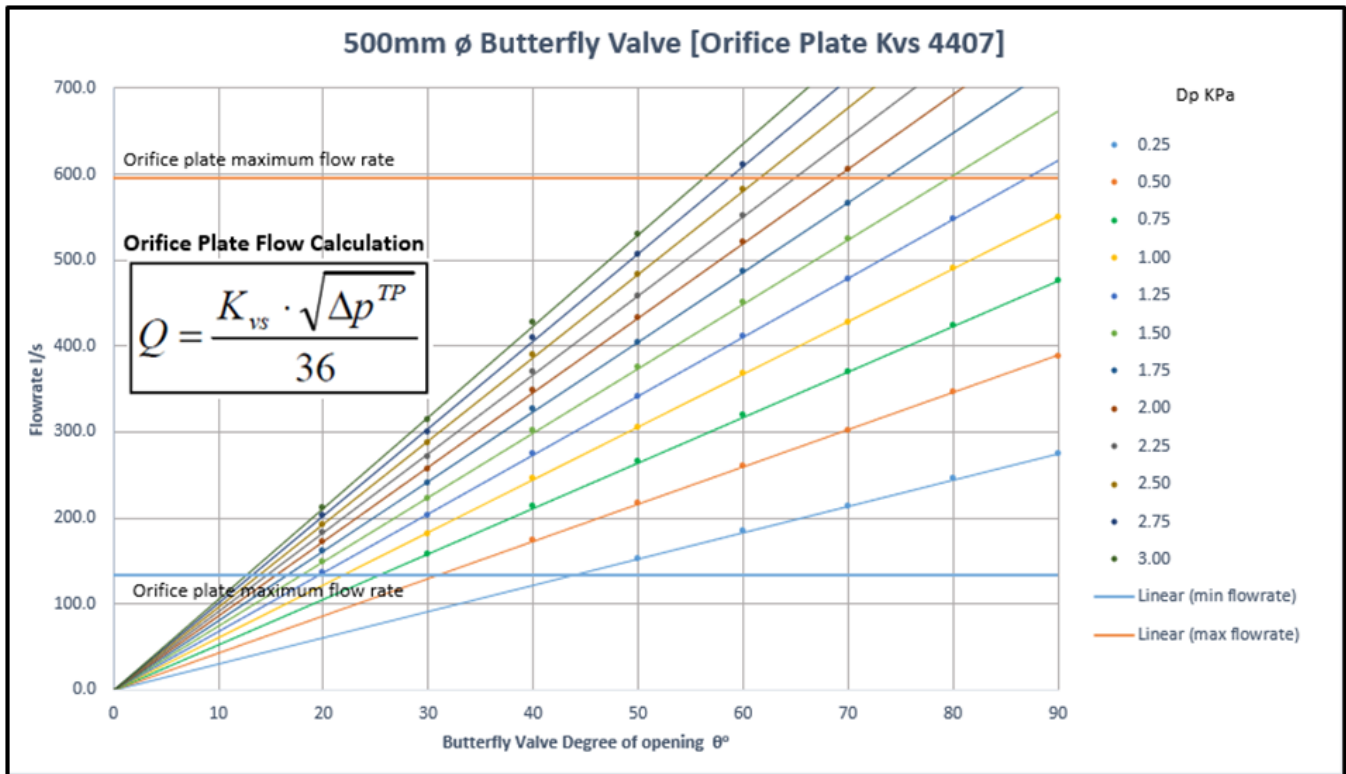



### SELECTIONS

600mm Butterfly Valve/Orifice Plate Commissioning Set

Flow range: 190 – 850.00 l/s

