

## APPLICATION

Fully lugged ductile iron Butterfly Valve with replaceable EPDM seat and stainless steel trim, fitted with gear operator for infinitely variable settings and stainless steel memory stop feature (DRV) to precisely set and retain the desired maximum opening position differential pressure. Once set, the valve can be closed and re-opened accurately to the pre-set differential pressure.

Commercially attractive option compared to traditional Globe-style Double Regulating Valves. Space saving and easier to support when weight is a concern. Available in large sizes up-to and including 600mm diameter. To measure  $\Delta P$ , Pressure/Temperature plugs are to be installed in the pipework on either side of the valve.

## SPECIFICATION

Body:	Ductile Iron
Disc, Pin & Stem:	Stainless Steel
Seat:	Replaceable EPDM
Operation:	Gearbox in Ductile Iron
Coating:	Epoxy
Standard:	BS EN 593
Dimensions:	BS EN 1092-2
Type:	<ul style="list-style-type: none"> <li>• Drilling: PN16</li> <li>• Shaft: SS AISI 410</li> <li>• Thread: Metric</li> </ul>
Tests:	Inspected and tested according to European PED #2014/68/EU, 15/05/2014
Size:	Standard 65mm—600mm
Temperature Range:	-15 to 85 °C
Max. Working Pressure:	16 Bar

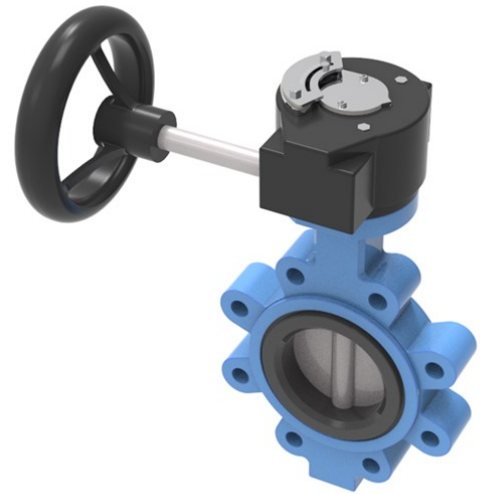

## FEATURES AND BENEFITS

- Robust ductile iron Butterfly Valve for long service life
- Easy to install and operate fully lugged gear operated Butterfly Valve
- Easy to set, positive position and reset memory stop feature
- Light weight and low cost
- Alternative product versions available on request, e.g. PN25 and vulcanised seats. A lead time may apply.

## PRODUCT CODES AND DIMENSIONS

Product Code	Size (DN)	Valve						Gearbox					
		L	L1	A	B	PCD	N-M	L1	L2	L3	L4	H	Ø
LUGN50065MDVEPR1683DRV	65	150.4	76	44.5	49.1	Ø145	4-M16	52	118	129	-	70	150
LUGN50080MDVEPR1683DRV	80	156.4	98.6	44.5	49.1	Ø160	8-M16						
LUGN50100MDVEPR1683DRV	100	167.9	118.7	51	55.5	Ø180	8-M16						
LUGN50125MDVEPR1683DRV	125	186.5	129.4	54.5	58.8	Ø210	8-M16						
LUGN50150MDVEPR1683DRV	150	205.7	142	54.5	59.1	Ø240	8-M20	75	191	171	-	80	280
LUGN50200MDVEPR1683DRV	200	230.6	176	59.6	64.1	Ø295	12-M20						
LUGN50250MDVEPR1683DRV	250	269.9	208.8	67	71.8	Ø355	12-M24	80	186	198	-	80	280
LUGN50300MDVEPR1683DRV	300	327.8	248.5	75.5	79.5	Ø410	12-M24						
LUGN50350MDVEPR1683DRV	350	368	267	76	81	-	-	125	273	280	-	80	400
LUGN50400MDVEPR1683DRV	400	400	309	102	107	-	-						
LUGN50450MDVEPR1683DRV	450	422	327	114	119	-	-	107	260	175	107	99	385
LUGN50500MDVEPR1683DRV	500	480	361	127	132.5	-	-						
LUGN50600MDVEPR1683DRV	600	562	459	151	157.5	-	-						

Dimensions are in mm

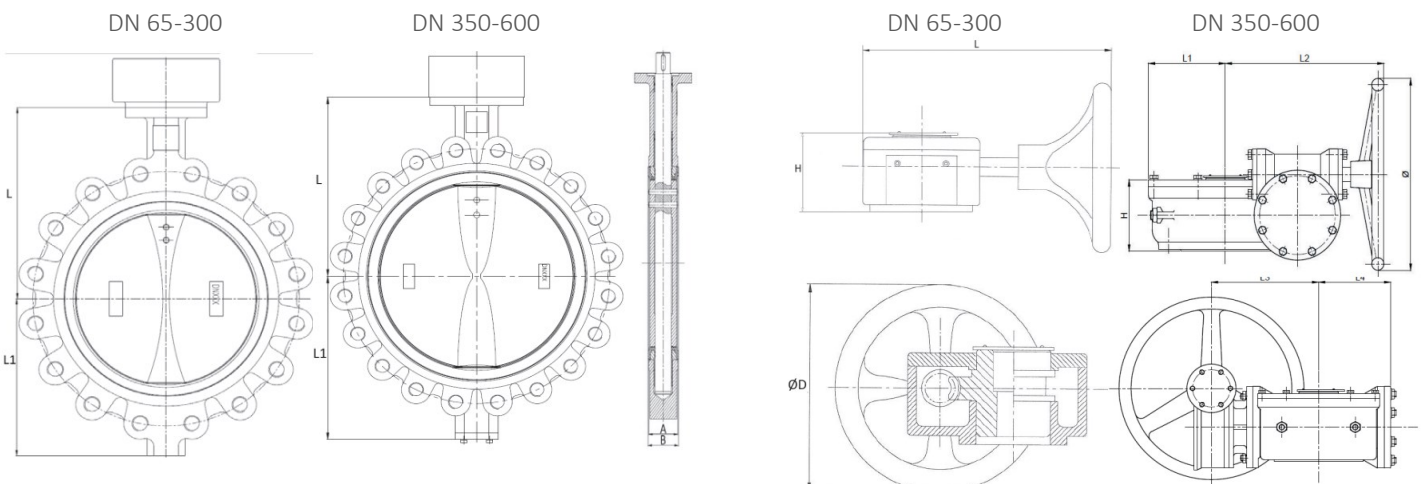

### SELECTIONS

65mm Butterfly Valve Double Regulating Butterfly Valve  
 Flow range: 1.0 – 19.0 l/s  
 $\Delta P$  range: 1.0 – 12.0 Kpa

80mm Butterfly Valve Double Regulating Butterfly Valve  
 Flow range: 2.0 – 30.0 l/s  
 $\Delta P$  range: 1.0 – 12.0 Kpa

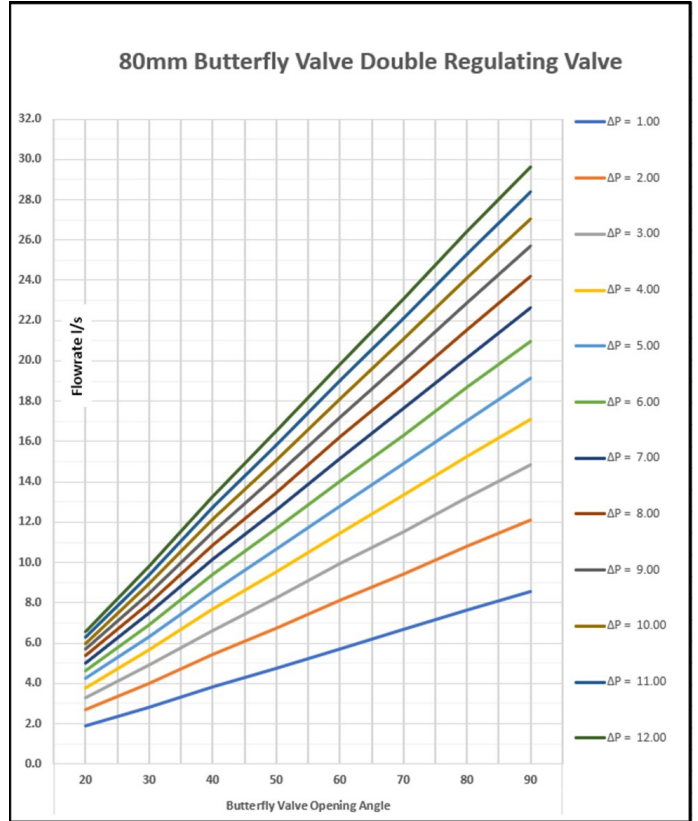
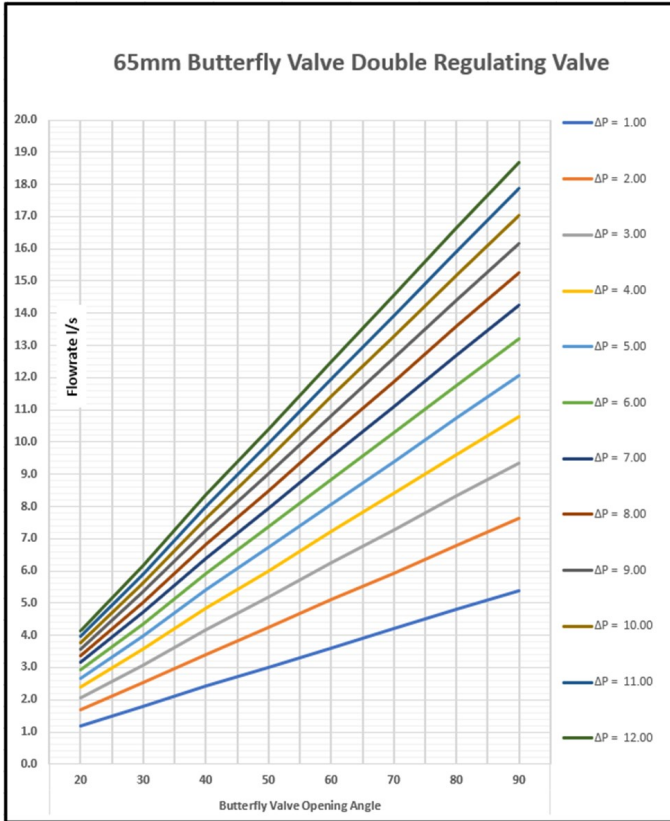

100mm Butterfly Valve Double Regulating Butterfly Valve  
 Flow range: 3.0 – 54.0 l/s  
 $\Delta P$  range: 1.0 – 12.0 Kpa

125mm Butterfly Valve Double Regulating Butterfly Valve  
 Flow range: 5.0 – 87.0 l/s  
 $\Delta P$  range: 1.0 – 12.0 Kpa

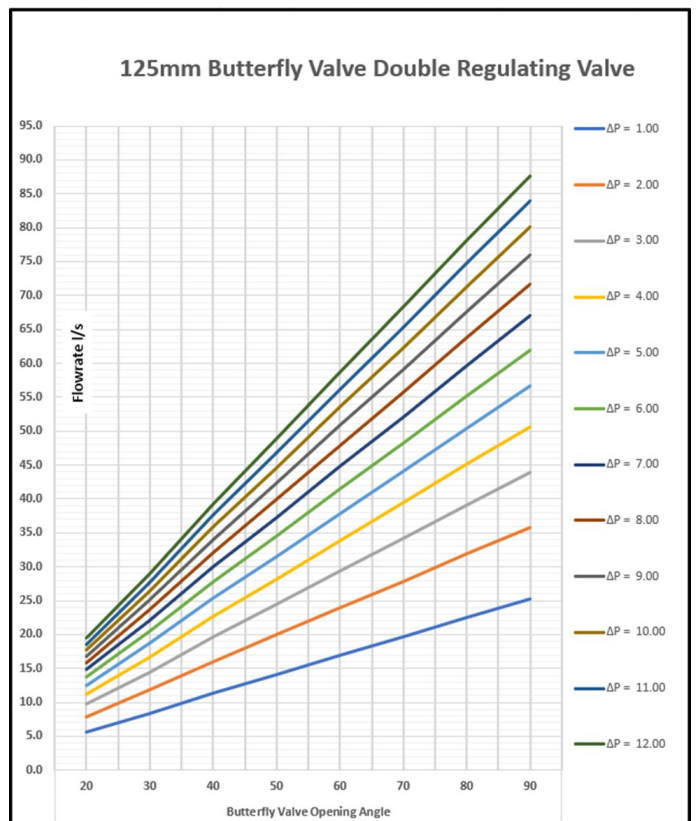
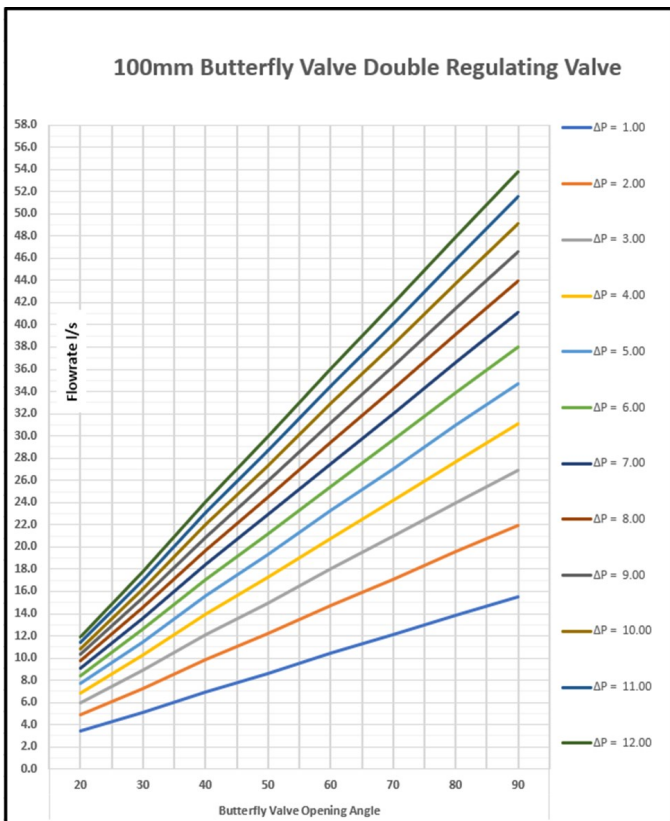

150mm Butterfly Valve Double Regulating Butterfly Valve  
 Flow range: 10.0 – 135.0 l/s  
 ΔP range: 1.0 – 12.0 Kpa

200mm Butterfly Valve Double Regulating Butterfly Valve  
 Flow range: 15.0 – 255.0 l/s  
 ΔP range: 1.0 – 12.0 Kpa

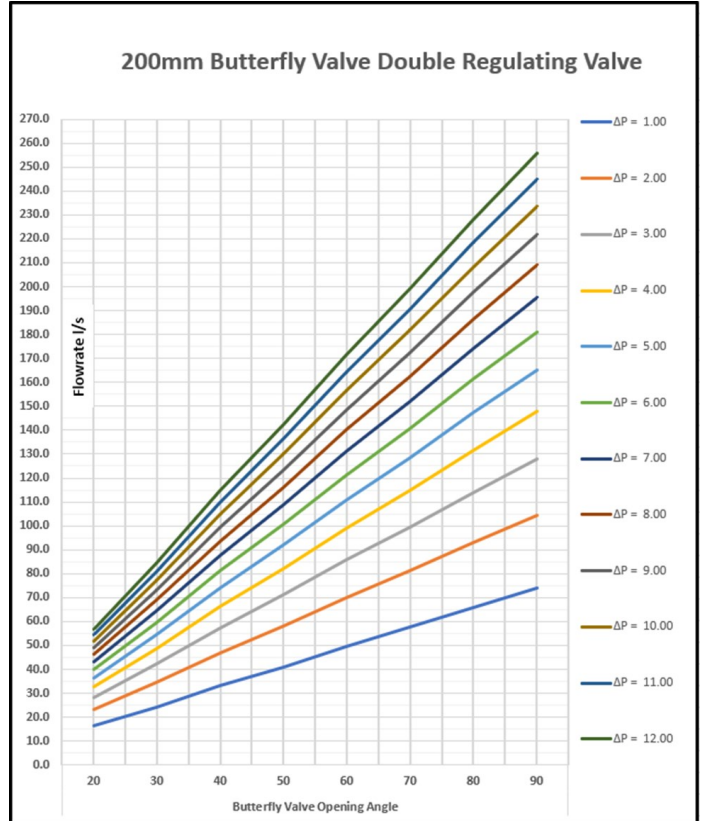
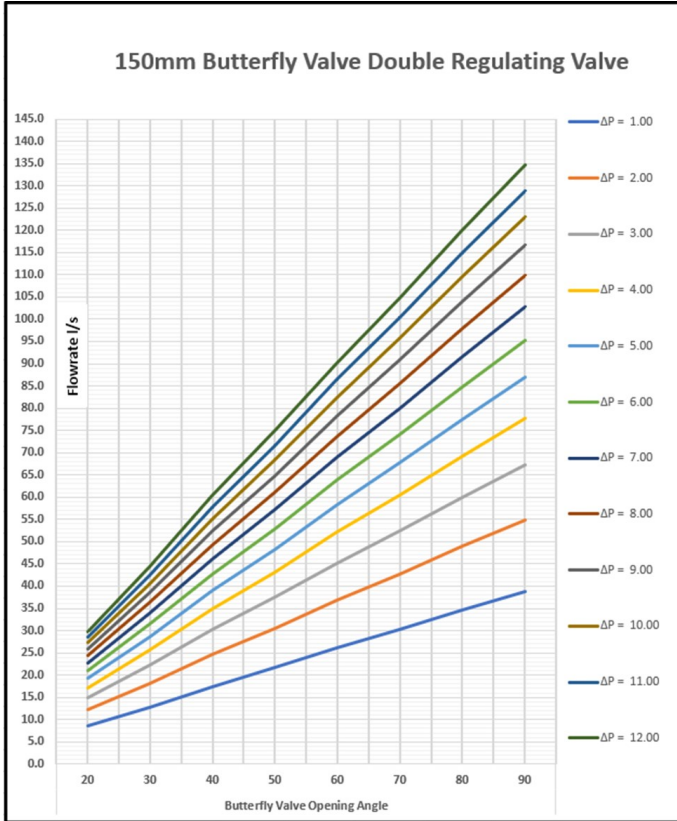

250mm Butterfly Valve Double Regulating Butterfly Valve  
 Flow range: 25.0 – 400.0 l/s  
 ΔP range: 1.0 – 12.0 Kpa

300mm Butterfly Valve Double Regulating Butterfly Valve  
 Flow range: 45.0 – 625.0 l/s  
 ΔP range: 1.0 – 12.0 Kpa

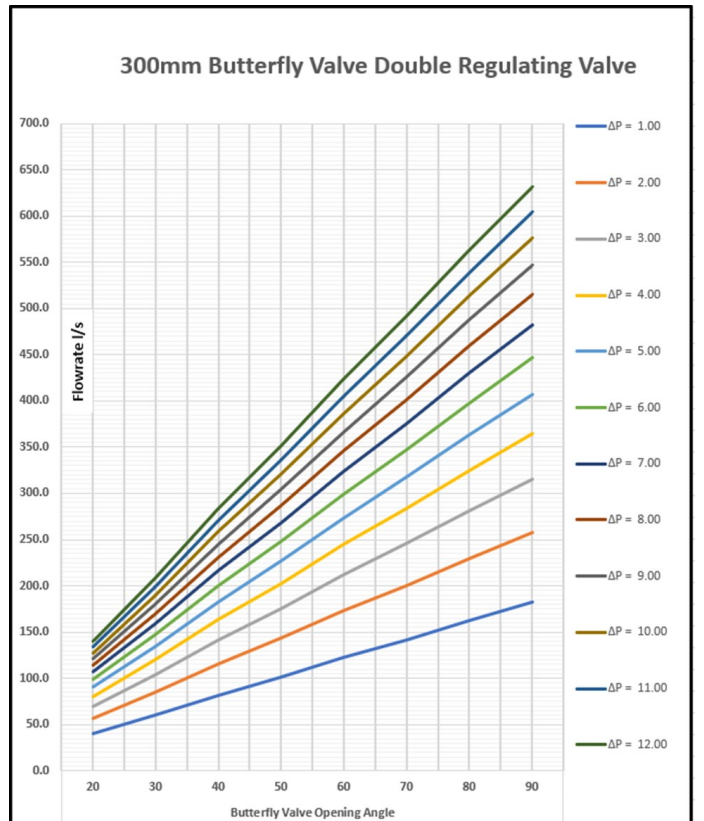
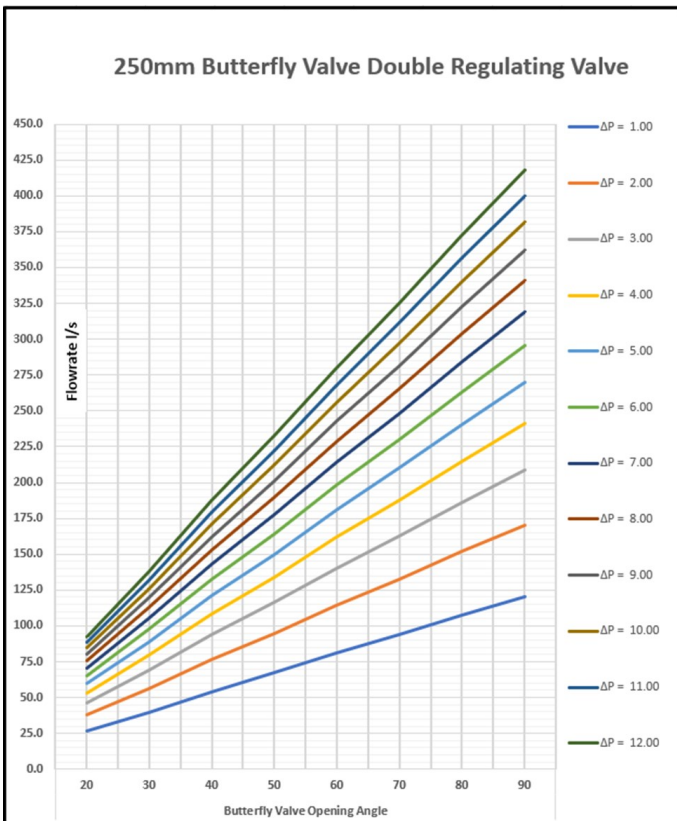

### SELECTIONS

350mm Butterfly Valve Double Regulating Butterfly Valve  
 Flow range: 50.0 – 900.0 l/s  
 ΔP range: 1.0 – 12.0 Kpa

400mm Butterfly Valve Double Regulating Butterfly Valve  
 Flow range: 100.0 – 1200.0 l/s  
 ΔP range: 1.0 – 12.0 Kpa

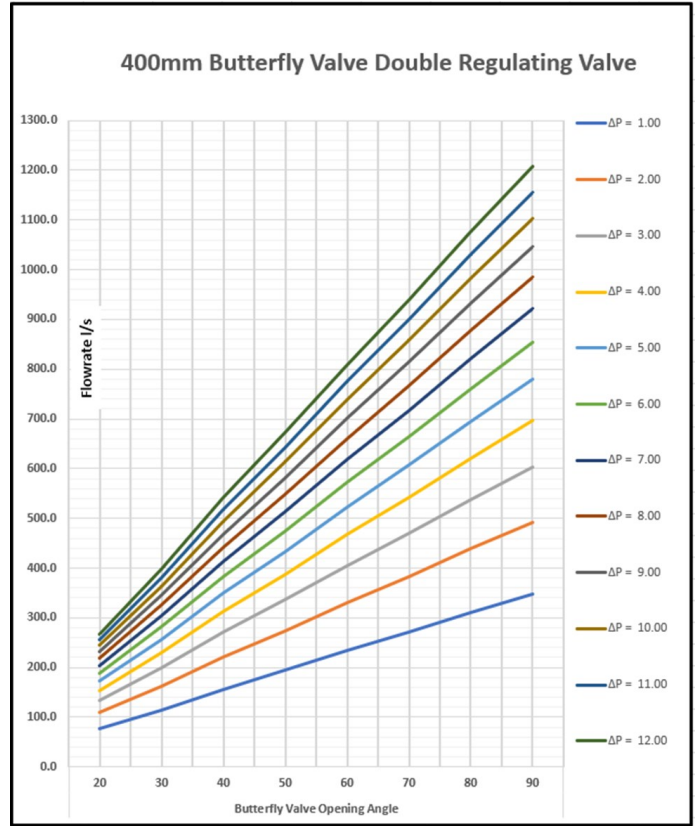
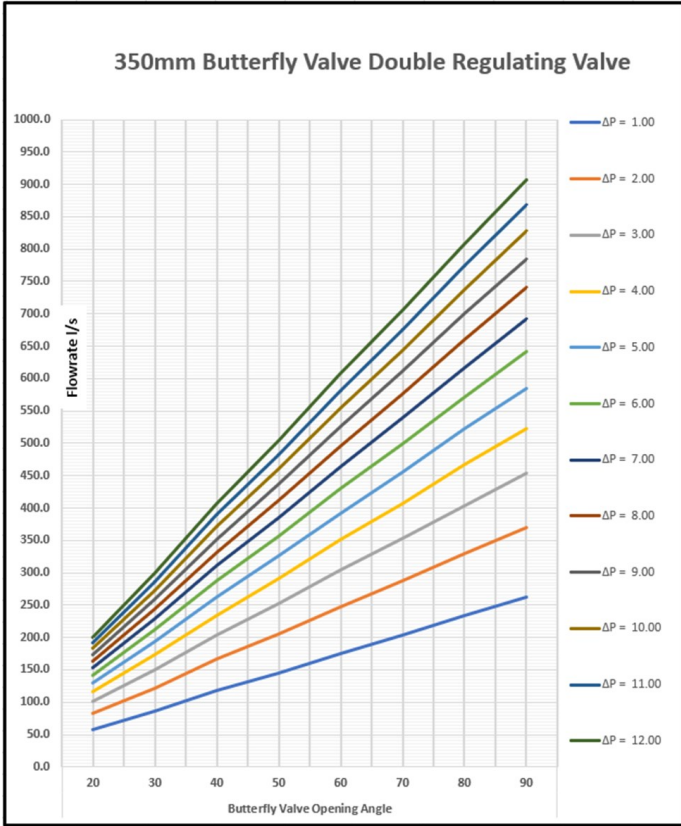

450mm Butterfly Valve Double Regulating Butterfly Valve  
 Flow range: 100.0 – 1500.0 l/s  
 ΔP range: 1.0 – 12.0 Kpa

500mm Butterfly Valve Double Regulating Butterfly Valve  
 Flow range: 130.0 – 1900.0 l/s  
 ΔP range: 1.0 – 12.0 Kpa

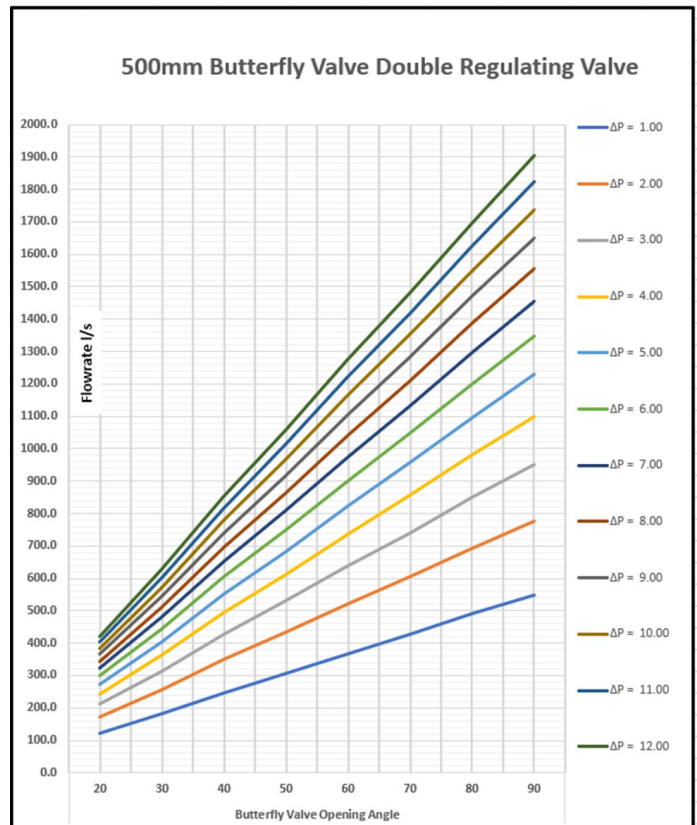
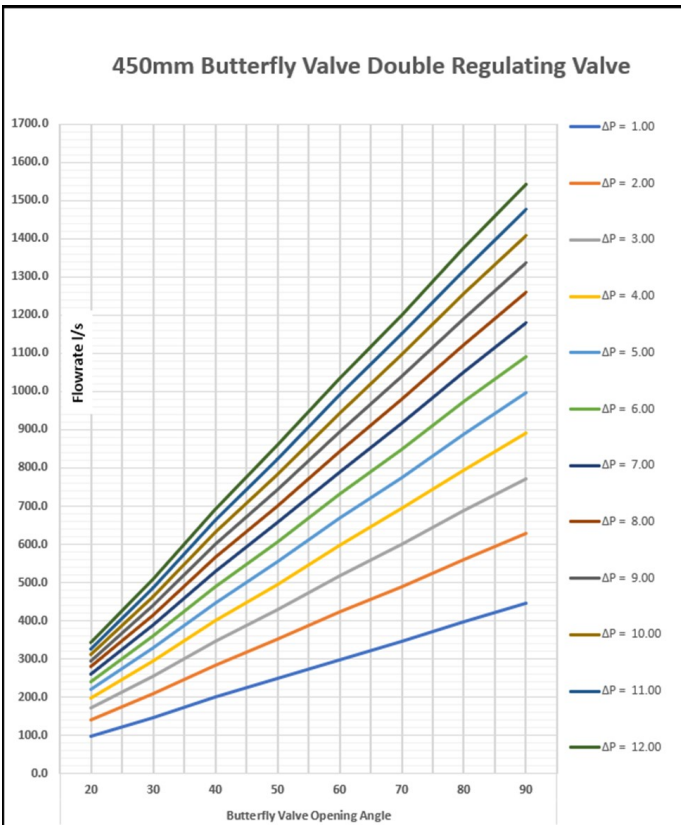

### SELECTIONS

600mm Butterfly Valve Double Regulating Butterfly Valve

Flow range: 200.0 – 2800.0 l/s

$\Delta P$  range: 1.0 – 12.0 Kpa

